



CME 413 FR.



6-litre electric fryer - 3 kW.

- Pressed stainless steel tank with cold zone.
- Drain valve.
- 60/180°C thermostat and safety thermostat.
- Removable heating element block.
- 15-minute timer.
- Electric supply: 230 V single phase.
- Supplied with a large basket.
- Supplied without oil trap.

CME 413 FR W 400 - D 650 - H 900

6-litre electric fryer - 3 kW

CME 413 FR

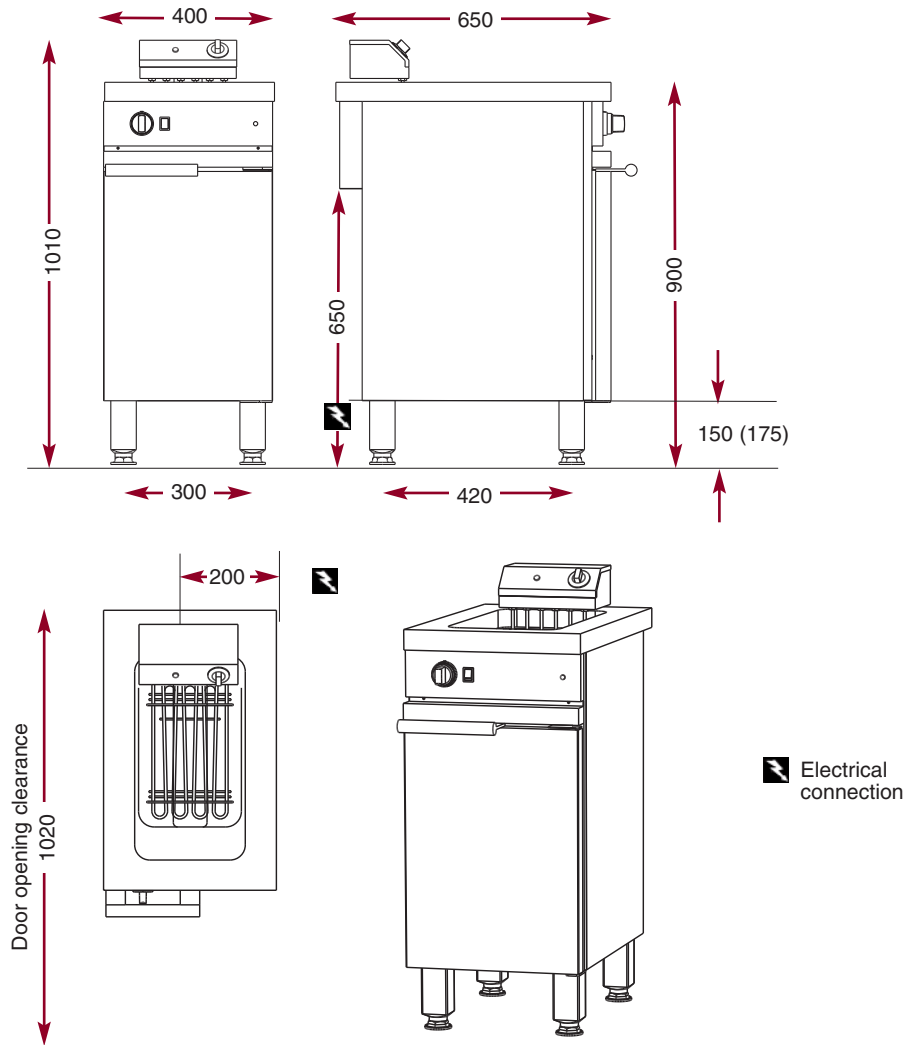

Pressed stainless steel tank for an easy cleaning and maintenance.
Large cold zone.

Expansion zone complying with standards.

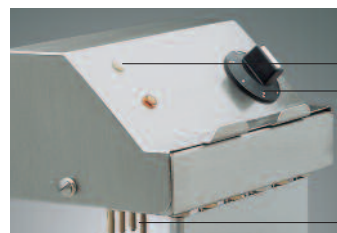

Temperature light indicator.
Main thermostat.

Safety thermostat.

Removable heating element unit.

Electric fryers' production rate (* whitened, then browned continuously).

Appareil	Frozen Fries* 9/9 mm			Fresh fries* 9/9 mm			Basket capacity (in g.)
	Cooking time (in mn.)	Hour production (in kg)	Number of portions	Cooking time (in mn.)	Hour production (in kg)	Number of portions	
E 413 FR	4'30"	6,5	40	4'30"	5,9	36	600

* Every fryer's thermostat being set on 180°C.



The Chef's Choice.